

FY25 PARKING LOT
MAINTENANCE,
SPRINGFIELD CAMPUS

Project Number: 250206-081

Project Issue Date: 03/31/2025

General Project Notes

1. ALL WORK SHALL BE DONE IN ACCORDANCE WITH THE INTERNATIONAL BUILDING CODE, 2012 EDITION.
2. THE DRAWINGS PROVIDED ARE DIAGRAMMATIC AND SHALL NOT BE SCALED. FIELD VERIFY ALL EXISITNG CONDITIONS.
3. PROVIDE SUBMITTALS AND SHOP DRAWINGS FOR ALL MATERIALS AND PRODUCTS TO BE USED ON THE PROJECT AS SOON AS POSSIBLE AFTER AWARD OF THE CONTRACT. THE SUBMITTALS SHALL BE REVIEWED FOR EQUAL QUALITY AND PERFORMANCE AS COMPARED TO THE SPECIFIED PRODUCTS. THE OWNER SHALL MAKE ALL FINAL DETERMINATIONS.
4. THE CONTRACTOR SHALL BE RESPONSIBLE FOR THE FULL COORDINATION OF THE WORK INCLUDING ALL SUB-CONTRACTORS AND WITH ANY OTHER CONTRACTORS ON THE PROJECT. CONFLICTS SHALL BE BROUGHT TO THE ATTENTION OF THE OWNER PRIOR TO THE START OF ANY WORK.
5. THE CONTRACTOR SHALL SCHEDULE AND EXECUTE ALL WORK WITH REGARD TO THE OWNER'S USE OF ADJACENT DRIVE ACCESS AS REQUIRED.
6. THE CONTRACTOR SHALL BE RESPONSIBLE FOR INSTALLING A COMPLETE AND FUNCTIONAL SYSTEM REGARDLESS OF WHETHER OR NOT ALL ELEMENTS ARE SPECIFICALLY CALLED OUT.
7. CONTRACTOR SHALL NOT BLOCK SIDEWALKS AND STREETS.
8. CONTRACTOR TO BE COURTEOUS AND POLITE AT ALL TIMES; OBSCENE LANGUAGE, GESTURES, ETC. WILL NOT BE TOLERATED.
9. CONTRACTOR TO FOLLOW MISSOURI STATE UNIVERSITY'S TOBACCO USE POLICY. MSU STRIVES TO ENSURE A HEALTHY LEARNING AND WORKING ENVIRONMENT BY PROMOTING A CULTURE OF HEALTH AND WELLNESS. MSU IS A TOBACCO-FREE CAMPUS.

Project Location Map

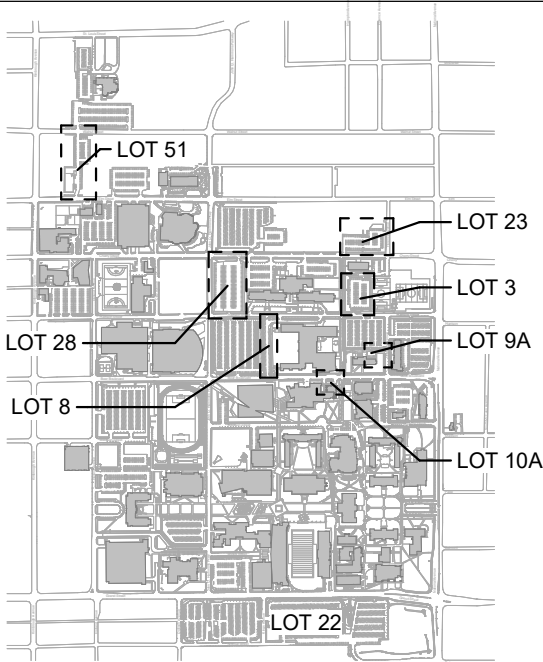

Sheet Index

A-00	COVER SHEET
A-01	SITE PLAN & SCOPE
A-02	LOT 8 PLAN
A-03	LOT 9A PLAN
A-04	LOT 23 PLAN
A-05	LOT 28 PLAN
A-06	LOT 51 PLAN
A-07	LOT 3 PLAN (ALTERNATE)
A-08	LOT 10A PLAN (ALTERNATE)
A-09	DETAILS
A-10	DETAILS

General Symbol Legend

X

KEYNOTE TAG

EXISTING LINE WORK

DEMOLITION LINE WORK

NEW LINE WORK

- PROVIDE STRIPING FOR NO PARKING

- PROVIDE STRIPING FOR CROSSWALK

- LOCATION OF ACCESSIBLE SPACE, SEE TYPICAL DETAIL ON SHEET A8

- LOCATION OF MOTORCYCLE SPACE

- EXISTING SIGNAGE

LP

- EXISTING LIGHT POLE

Missouri
State

UNIVERSITY

Planning | Design
Construction

901 South National Avenue
Springfield, Missouri 65897
Phone: (417) 836-5101
Fax: (417) 836-6884
<https://design.missouristate.edu>

Project Title:

FY25 PARKING LOT
MAINTENANCE,
SPRINGFIELD
CAMPUS

Project #: 250206-081

Issue Date: 03/31/2025

Drawn By: AJS

Sheet Title:

COVER SHEET

Sheet #:

A-00

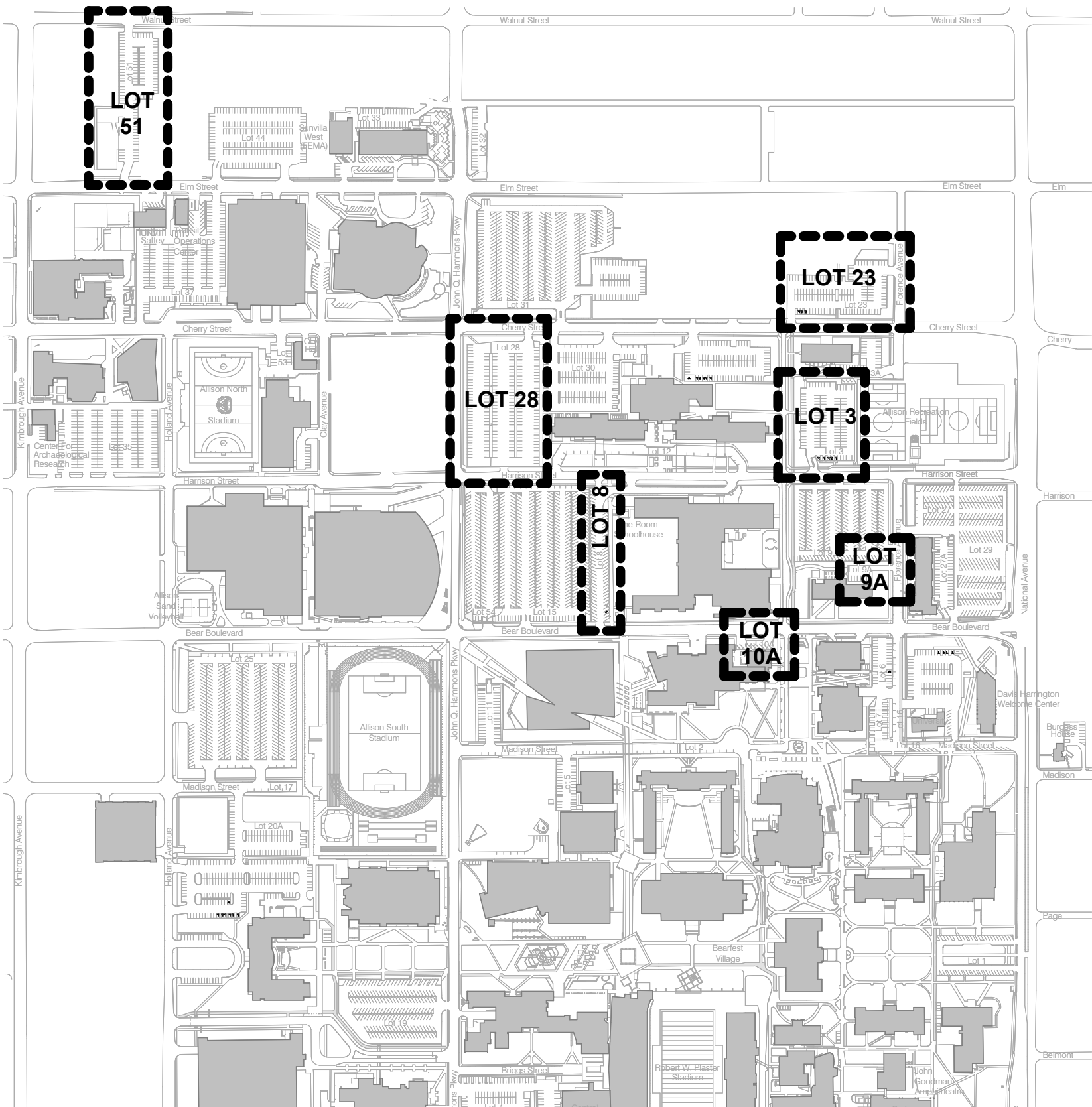

1
A-01

OVERALL SITE PLAN

1" = 400'-0"

NORTH

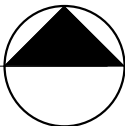

SCOPE SUMMARY

LOT NAME	EXISTING TOTAL AREA (SF)	PARKING COUNT	SEAL & STRIPE (SF)	ASPHALT REPAIRS (SF)	CONCRETE REPAIRS (SF)
LOT 8	35,200	75	33,900	3,400	400
LOT 9A	4,500	7	-	-	900
LOT 23	43,900	131	43,000	6,500	200
LOT 28	83,200	134	-	-	2,000
LOT 51	39,200	107	39,200	6,000	-

SUB-TOTAL: 116,100 15,900 3,500

ADD ALTERNATES:

LOT NAME	EXISTING TOTAL AREA (SF)	PARKING COUNT	SEAL & STRIPE (SF)	ASPHALT REPAIRS (SF)	CONCRETE REPAIRS (SF)
LOT 3	40,500	117	39,600	4,000	-
LOT 10A	3,800	8	3,400	200	-

SUB-TOTAL: 43,000 4,200 -

SCOPE SUMMARY NOTES:

SEAL & STRIPE:
REMOVE DIRT AND DEBRIS. PROVIDE GENERAL CLEANING OF PARKING LOT. FILL ALL CRACKS AND SEAL PARKING LOT WITH ASPHALT EMULSION AS SPECIFIED. RE-STRIPE PARKING LOT WITH THE LAYOUT AS SHOWN ON LOT PLANS.

ASPHALT REPAIRS:
REMOVE DIRT AND DEBRIS. PROVIDE GENERAL CLEANING OF PARKING LOT AREA TO BE REPAIRED. REMOVE AND REPLACE AREAS OF ASPHALT THAT ARE BROKEN, SPALLING, RUTTING, CRACKED OR DETERIORATING. RE-STRIPE PARKING LOT AS REQUIRED AROUND THE AREA OF WORK. COORDINATE LOCATION OF REPAIRS WITH OWNER PRIOR TO STARTING WORK. NOTIFY OWNER IF LAYOUT DOES NOT MATCH EXISTING CONDITIONS.

CONCRETE REPAIRS:
REMOVE DIRT AND DEBRIS. PROVIDE GENERAL CLEANING OF PARKING LOT AREA TO BE REPAIRED. REMOVE AND REPLACE AREAS OF CONCRETE THAT ARE BROKEN, SPALLING, RUTTING, CRACKED OR DETERIORATING. RE-STRIPE PARKING LOT AS REQUIRED AROUND THE AREA OF WORK. COORDINATE LOCATION OF REPAIRS WITH OWNER PRIOR TO STARTING WORK. NOTIFY OWNER IF LAYOUT DOES NOT MATCH EXISTING CONDITIONS.

Missouri State
UNIVERSITY

Planning | Design
Construction

901 South National Avenue
Springfield, Missouri 65897
Phone: (417) 836-5101
Fax: (417) 836-6884
<https://design.missouristate.edu>

Project Title:

FY25 PARKING LOT
MAINTENANCE,
SPRINGFIELD
CAMPUS

Project #: 250206-081

Issue Date: 03/31/2025

Drawn By: AJS

Sheet Title:

SITE PLAN &
SCOPE

Sheet #:

A-01

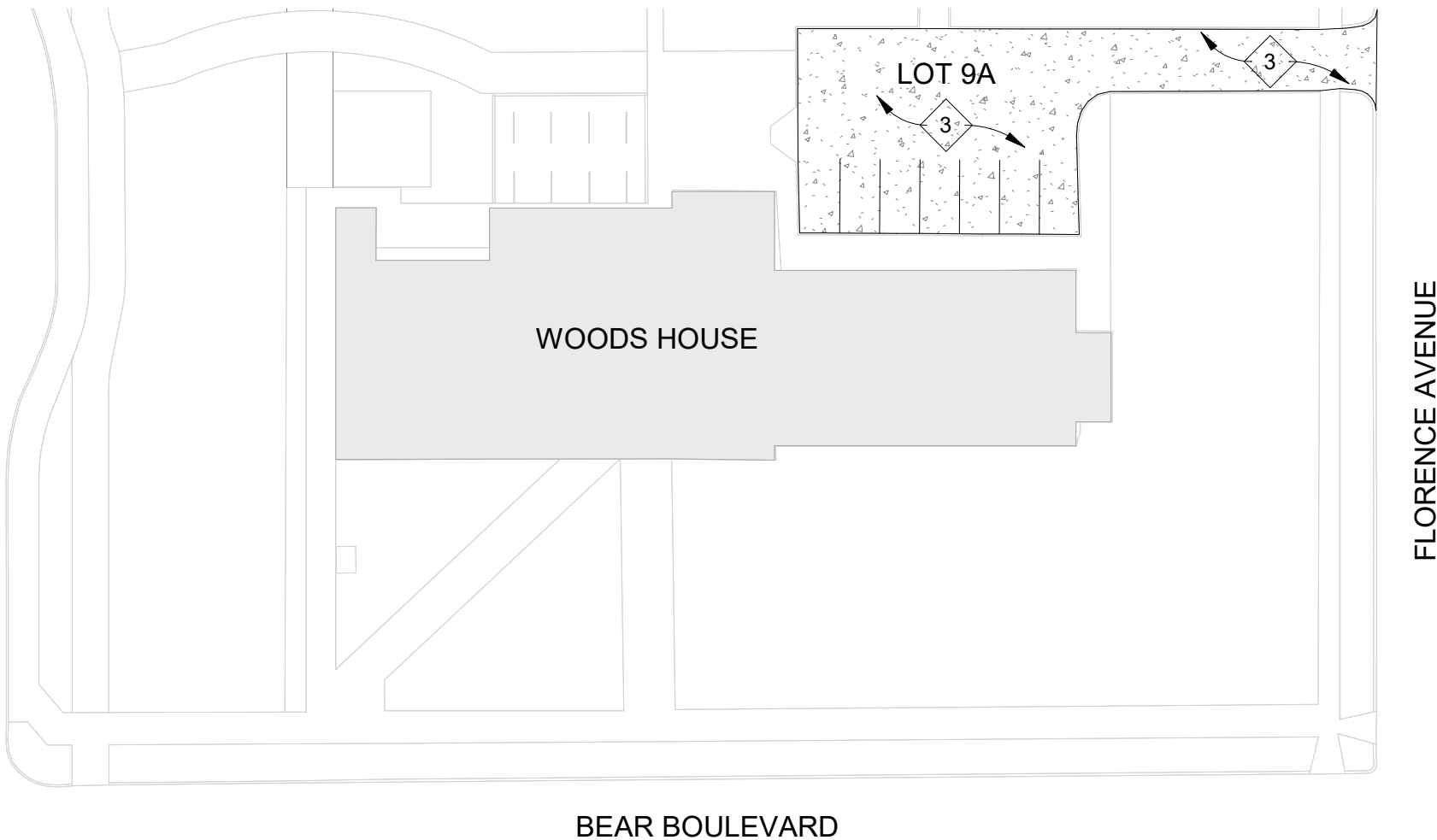

1

A-03

PARKING LOT 9A

1" = 40'-0"

NORTH

GENERAL NOTES

- SEE SHEET AT A-01 FOR OVERALL SCOPE SUMMARY OF WORK.
- ALL EXISTING SIGNS, WHEEL STOPS, UTILITIES, LIGHT POLES TO REMAIN, UNLESS OTHERWISE NOTED. NOTIFY PROJECT MANAGER IF EQUIPMENT IS DAMAGED AND NEEDS REPLACED.
- CONTRACTOR TO VERIFY EXISTING CONDITIONS PRIOR TO BID.
- ANY DAMAGE TO THE SITE OUTSIDE THE CONTRACT AREA SHALL BE THE RESPONSIBILITY OF THE CONTRACTOR. THE CONTRACTOR SHALL REPAIR OR REPLACE ANY SUCH ITEMS, PROVIDE LABOR, MATERIAL AND CLEAN-UP, AT THE CONTRACTOR'S EXPENSE AND TO THE SATISFACTION OF MSU WITHOUT ADDITIONAL COSTS.
- CONTRACTOR IS TO BE AWARE OF UNDERGROUND COMMUNICATIONS, UNDERGROUND ELECTRIC AND THE CONTRACTOR IS TO USE CAUTION WHEN MAKING ADJUSTMENTS TO AND/OR WORKING ABOVE OR NEAR THESE UTILITIES. CONTRACTORS ARE RESPONSIBLE FOR LOCATING UTILITIES AS MAY BE NECESSARY TO AVOID DAMAGE.

KEYED NOTES

- 1

SEAL AND STRIPE: REMOVE DIRT / DEBRIS AND PROVIDE GENERAL CLEANING OF PARKING LOT. FILL ALL CRACKS AND SEAL PARKING LOT WITH AS SPECIFIED. RE-STRIPE PARKING LOT WITH THE LAYOUT INDICATED.
- 2

ASPHALT REPAIRS: REMOVE DIRT / DEBRIS AND PROVIDE GENERAL CLEANING OF PARKING LOT. REMOVE AND REPLACE AREAS OF ASPHALT THAT ARE BROKEN, SPALLING, RUTTING, CRACKED OR DETERIORATING. RE-STRIPE PARKING LOT WITH THE LAYOUT INDICATED ON DRAWING. COORDINATE LOCATION OF REPAIRS WITH OWNER PRIOR TO STARTING WORK. NOTIFY OWNER IF LAYOUT DOES NOT MATCH EXISTING CONDITIONS.
- 3

CONCRETE REPAIRS: REMOVE DIRT / DEBRIS AND PROVIDE GENERAL CLEANING OF PARKING LOT. REMOVE AND REPLACE AREAS OF CONCRETE THAT ARE BROKEN, SPALLING, RUTTING, CRACKED OR DETERIORATING. RE-STRIPE PARKING LOT WITH THE LAYOUT INDICATED ON DRAWING. COORDINATE LOCATION OF REPAIRS WITH OWNER PRIOR TO STARTING WORK. NOTIFY OWNER IF LAYOUT DOES NOT MATCH EXISTING CONDITIONS.
- 4

ADA PARKING: AREA TO BE CONVERTED TO ADA COMPLIANT DISABLED PARKING. REMOVE AND REPLACE ASPHALT AS REQUIRED TO ENSURE NEW ADA COMPLIANT DISABLED PARKING MEETS ALL REQUIREMENTS. RE-STRIPE PARKING LOT WITH THE LAYOUT INDICATED ON DRAWING. REFERENCE DETAIL DRAWING SHEETS.
- 5

SIGN POST: INSTALL NEW SIGN POST AND COORDINATE LANDSCAPING WITH OWNER.

Missouri State

UNIVERSITY

Planning | Design Construction

901 South National Avenue
Springfield, Missouri 65897
Phone: (417) 836-5101
Fax: (417) 836-6884
<https://design.missouristate.edu>

Project Title:

FY25 PARKING LOT MAINTENANCE, SPRINGFIELD CAMPUS

Project #:

250206-081

Issue Date:

03/31/2025

Drawn By:

AJS

Sheet Title:

LOT 9A PLAN

Sheet #:

A-03

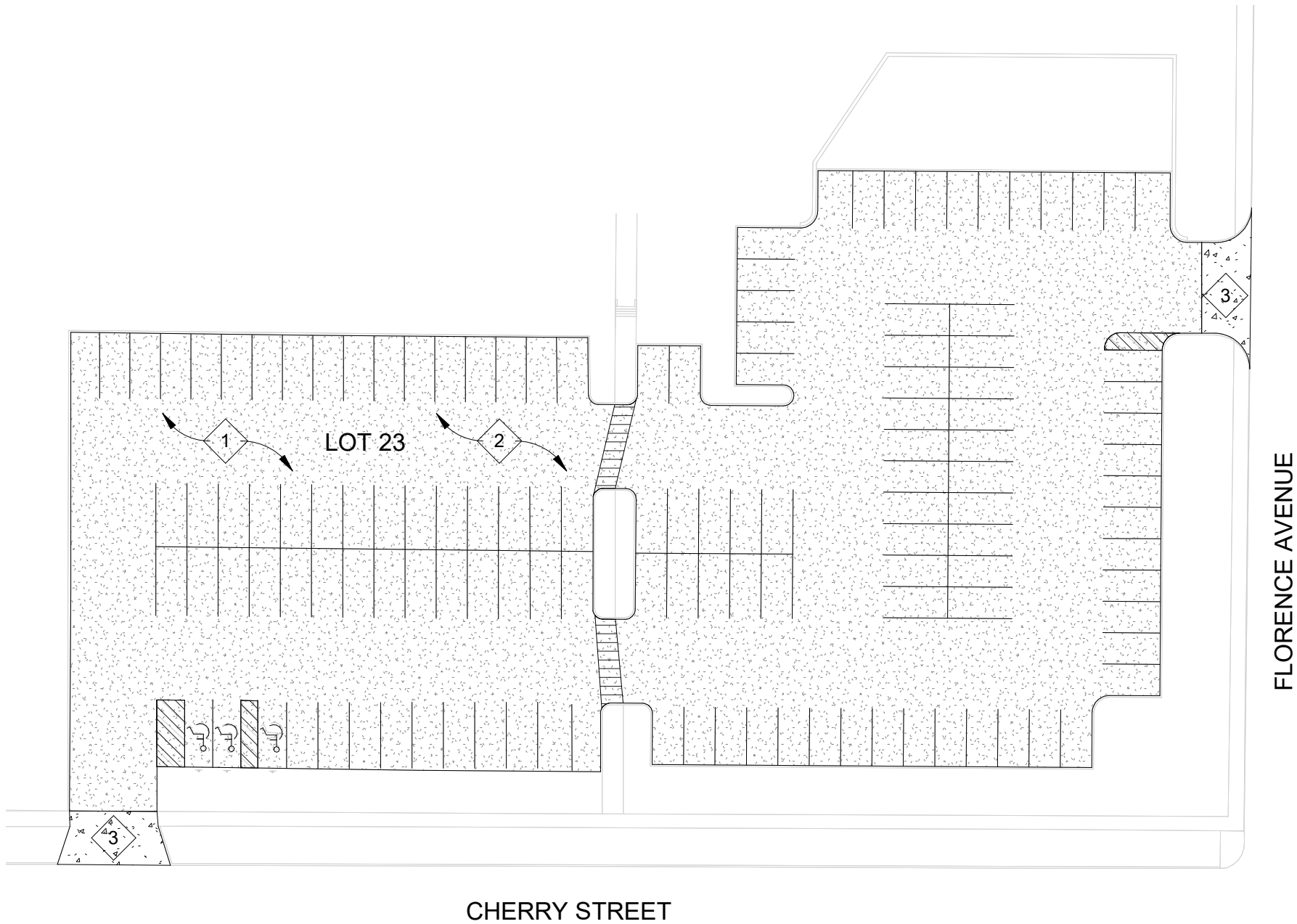

1

A-04

PARKING LOT 23

1" = 40'-0"



GENERAL NOTES

1. SEE SHEET AT A-01 FOR OVERALL SCOPE SUMMARY OF WORK.
2. ALL EXISTING SIGNS, WHEEL STOPS, UTILITIES, LIGHT POLES TO REMAIN, UNLESS OTHERWISE NOTED. NOTIFY PROJECT MANAGER IF EQUIPMENT IS DAMAGED AND NEEDS REPLACED.
3. CONTRACTOR TO VERIFY EXISTING CONDITIONS PRIOR TO BID.
4. ANY DAMAGE TO THE SITE OUTSIDE THE CONTRACT AREA SHALL BE THE RESPONSIBILITY OF THE CONTRACTOR. THE CONTRACTOR SHALL REPAIR OR REPLACE ANY SUCH ITEMS, PROVIDE LABOR, MATERIAL AND CLEAN-UP, AT THE CONTRACTOR'S EXPENSE AND TO THE SATISFACTION OF MSU WITHOUT ADDITIONAL COSTS.
5. CONTRACTOR IS TO BE AWARE OF UNDERGROUND COMMUNICATIONS, UNDERGROUND ELECTRIC AND THE CONTRACTOR IS TO USE CAUTION WHEN MAKING ADJUSTMENTS TO AND/OR WORKING ABOVE OR NEAR THESE UTILITIES. CONTRACTORS ARE RESPONSIBLE FOR LOCATING UTILITIES AS MAY BE NECESSARY TO AVOID DAMAGE.

KEYED NOTES

- 1

SEAL AND STRIPE: REMOVE DIRT / DEBRIS AND PROVIDE GENERAL CLEANING OF PARKING LOT. FILL ALL CRACKS AND SEAL PARKING LOT WITH AS SPECIFIED. RE-STRIPE PARKING LOT WITH THE LAYOUT INDICATED.
- 2

ASPHALT REPAIRS: REMOVE DIRT / DEBRIS AND PROVIDE GENERAL CLEANING OF PARKING LOT. REMOVE AND REPLACE AREAS OF ASPHALT THAT ARE BROKEN, SPALLING, RUTTING, CRACKED OR DETERIORATING. RE-STRIPE PARKING LOT WITH THE LAYOUT INDICATED ON DRAWING. COORDINATE LOCATION OF REPAIRS WITH OWNER PRIOR TO STARTING WORK. NOTIFY OWNER IF LAYOUT DOES NOT MATCH EXISTING CONDITIONS.
- 3

CONCRETE REPAIRS: REMOVE DIRT / DEBRIS AND PROVIDE GENERAL CLEANING OF PARKING LOT. REMOVE AND REPLACE AREAS OF CONCRETE THAT ARE BROKEN, SPALLING, RUTTING, CRACKED OR DETERIORATING. RE-STRIPE PARKING LOT WITH THE LAYOUT INDICATED ON DRAWING. COORDINATE LOCATION OF REPAIRS WITH OWNER PRIOR TO STARTING WORK. NOTIFY OWNER IF LAYOUT DOES NOT MATCH EXISTING CONDITIONS.
- 4

ADA PARKING: AREA TO BE CONVERTED TO ADA COMPLIANT DISABLED PARKING. REMOVE AND REPLACE ASPHALT AS REQUIRED TO ENSURE NEW ADA COMPLIANT DISABLED PARKING MEETS ALL REQUIREMENTS. RE-STRIPE PARKING LOT WITH THE LAYOUT INDICATED ON DRAWING. REFERENCE DETAIL DRAWING SHEETS.
- 5

SIGN POST: INSTALL NEW SIGN POST AND COORDINATE LANDSCAPING WITH OWNER.

Missouri
State

UNIVERSITY

Planning | Design
Construction

901 South National Avenue
Springfield, Missouri 65897
Phone: (417) 836-5101
Fax: (417) 836-6884
<https://design.missouristate.edu>

Project Title:

FY25 PARKING LOT
MAINTENANCE,
SPRINGFIELD
CAMPUS

Project #: 250206-081

Issue Date: 03/31/2025

Drawn By: AJS

Sheet Title:

LOT 23 PLAN

Sheet #:

A-04

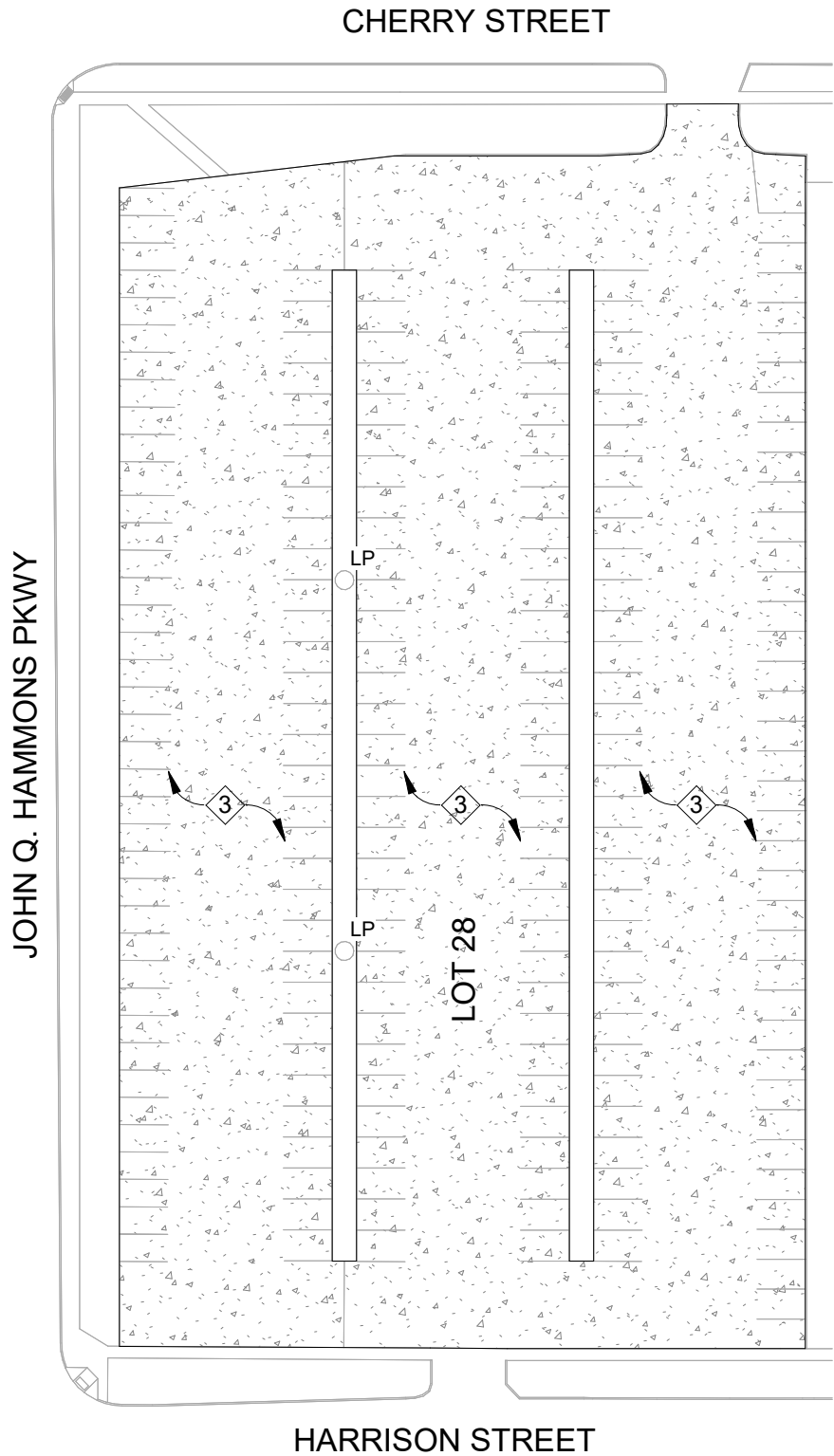

GENERAL NOTES

1. SEE SHEET AT A-01 FOR OVERALL SCOPE SUMMARY OF WORK.
2. ALL EXISTING SIGNS, WHEEL STOPS, UTILITIES, LIGHT POLES TO REMAIN, UNLESS OTHERWISE NOTED. NOTIFY PROJECT MANAGER IF EQUIPMENT IS DAMAGED AND NEEDS REPLACED.
3. CONTRACTOR TO VERIFY EXISTING CONDITIONS PRIOR TO BID.
4. ANY DAMAGE TO THE SITE OUTSIDE THE CONTRACT AREA SHALL BE THE RESPONSIBILITY OF THE CONTRACTOR. THE CONTRACTOR SHALL REPAIR OR REPLACE ANY SUCH ITEMS, PROVIDE LABOR, MATERIAL AND CLEAN-UP, AT THE CONTRACTOR'S EXPENSE AND TO THE SATISFACTION OF MSU WITHOUT ADDITIONAL COSTS.
5. CONTRACTOR IS TO BE AWARE OF UNDERGROUND COMMUNICATIONS, UNDERGROUND ELECTRIC AND THE CONTRACTOR IS TO USE CAUTION WHEN MAKING ADJUSTMENTS TO AND/OR WORKING ABOVE OR NEAR THESE UTILITIES. CONTRACTORS ARE RESPONSIBLE FOR LOCATING UTILITIES AS MAY BE NECESSARY TO AVOID DAMAGE.

KEYED NOTES

- 1 **SEAL AND STRIPE:** REMOVE DIRT / DEBRIS AND PROVIDE GENERAL CLEANING OF PARKING LOT. FILL ALL CRACKS AND SEAL PARKING LOT WITH AS SPECIFIED. RE-STRIPE PARKING LOT WITH THE LAYOUT INDICATED.
- 2 **ASPHALT REPAIRS:** REMOVE DIRT / DEBRIS AND PROVIDE GENERAL CLEANING OF PARKING LOT. REMOVE AND REPLACE AREAS OF ASPHALT THAT ARE BROKEN, SPALLING, RUTTING, CRACKED OR DETERIORATING. RE-STRIPE PARKING LOT WITH THE LAYOUT INDICATED ON DRAWING. COORDINATE LOCATION OF REPAIRS WITH OWNER PRIOR TO STARTING WORK. NOTIFY OWNER IF LAYOUT DOES NOT MATCH EXISTING CONDITIONS.
- 3 **CONCRETE REPAIRS:** REMOVE DIRT / DEBRIS AND PROVIDE GENERAL CLEANING OF PARKING LOT. REMOVE AND REPLACE AREAS OF CONCRETE THAT ARE BROKEN, SPALLING, RUTTING, CRACKED OR DETERIORATING. RE-STRIPE PARKING LOT WITH THE LAYOUT INDICATED ON DRAWING. COORDINATE LOCATION OF REPAIRS WITH OWNER PRIOR TO STARTING WORK. NOTIFY OWNER IF LAYOUT DOES NOT MATCH EXISTING CONDITIONS.
- 4 **ADA PARKING:** AREA TO BE CONVERTED TO ADA COMPLIANT DISABLED PARKING. REMOVE AND REPLACE ASPHALT AS REQUIRED TO ENSURE NEW ADA COMPLIANT DISABLED PARKING MEETS ALL REQUIREMENTS. RE-STRIPE PARKING LOT WITH THE LAYOUT INDICATED ON DRAWING. REFERENCE DETAIL DRAWING SHEETS.
- 5 **SIGN POST:** INSTALL NEW SIGN POST AND COORDINATE LANDSCAPING WITH OWNER.

Missouri
State

UNIVERSITY

Planning | Design
Construction

901 South National Avenue
Springfield, Missouri 65897
Phone: (417) 836-5101
Fax: (417) 836-6884
<https://design.missouristate.edu>

Project Title:

**FY25 PARKING LOT
MAINTENANCE,
SPRINGFIELD
CAMPUS**

Project #: **250206-081**

Issue Date: **03/31/2025**

Drawn By: **AJS**

Sheet Title:

LOT 28 PLAN

Sheet #:

A-05

1 **PARKING LOT 28**
A-05 1" = 60'-0"



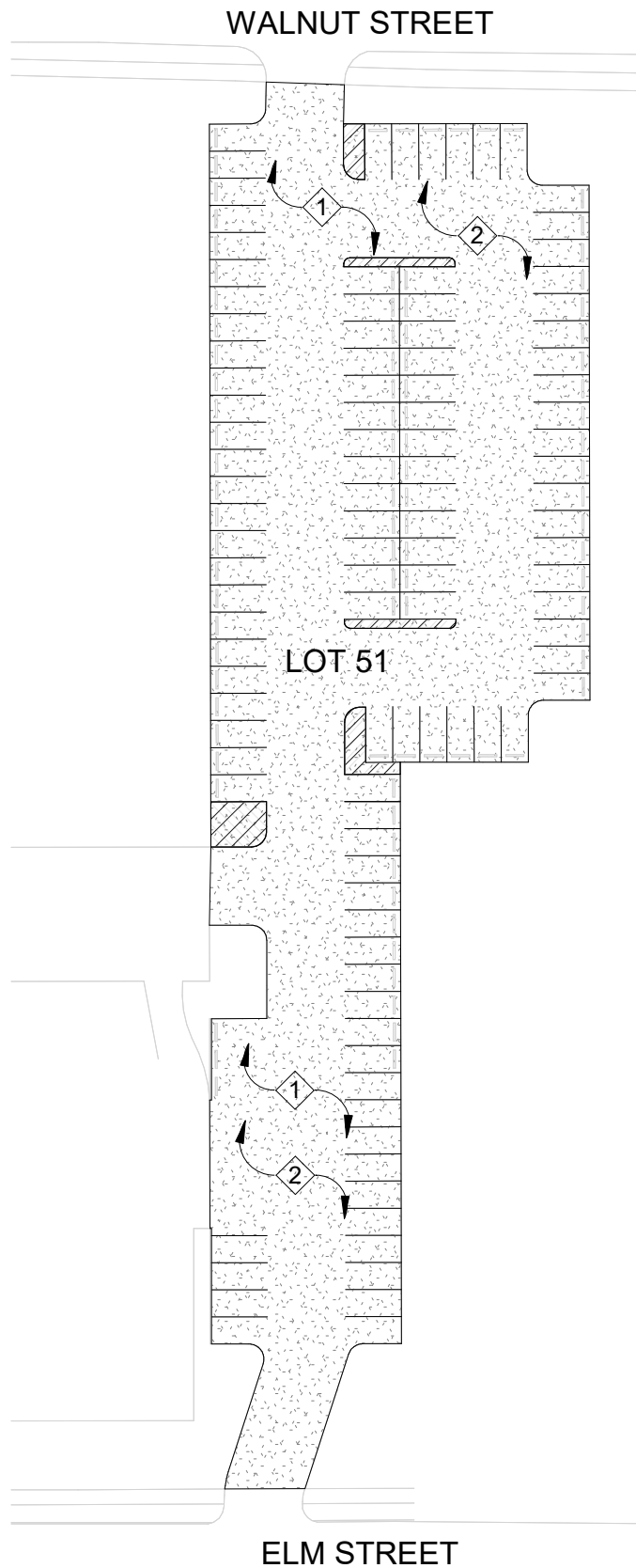

GENERAL NOTES

- 1. SEE SHEET AT A-01 FOR OVERALL SCOPE SUMMARY OF WORK.
- 2. ALL EXISTING SIGNS, WHEEL STOPS, UTILITIES, LIGHT POLES TO REMAIN, UNLESS OTHERWISE NOTED. NOTIFY PROJECT MANAGER IF EQUIPMENT IS DAMAGED AND NEEDS REPLACED.
- 3. CONTRACTOR TO VERIFY EXISTING CONDITIONS PRIOR TO BID.
- 4. ANY DAMAGE TO THE SITE OUTSIDE THE CONTRACT AREA SHALL BE THE RESPONSIBILITY OF THE CONTRACTOR. THE CONTRACTOR SHALL REPAIR OR REPLACE ANY SUCH ITEMS, PROVIDE LABOR, MATERIAL AND CLEAN-UP, AT THE CONTRACTOR'S EXPENSE AND TO THE SATISFACTION OF MSU WITHOUT ADDITIONAL COSTS.
- 5. CONTRACTOR IS TO BE AWARE OF UNDERGROUND COMMUNICATIONS, UNDERGROUND ELECTRIC AND THE CONTRACTOR IS TO USE CAUTION WHEN MAKING ADJUSTMENTS TO AND/OR WORKING ABOVE OR NEAR THESE UTILITIES. CONTRACTORS ARE RESPONSIBLE FOR LOCATING UTILITIES AS MAY BE NECESSARY TO AVOID DAMAGE.

KEYED NOTES

- 1. SEAL AND STRIPE: REMOVE DIRT / DEBRIS AND PROVIDE GENERAL CLEANING OF PARKING LOT. FILL ALL CRACKS AND SEAL PARKING LOT WITH AS SPECIFIED. RE-STRIPE PARKING LOT WITH THE LAYOUT INDICATED.
- 2. ASPHALT REPAIRS: REMOVE DIRT / DEBRIS AND PROVIDE GENERAL CLEANING OF PARKING LOT. REMOVE AND REPLACE AREAS OF ASPHALT THAT ARE BROKEN, SPALLING, RUTTING, CRACKED OR DETERIORATING. RE-STRIPE PARKING LOT WITH THE LAYOUT INDICATED ON DRAWING. COORDINATE LOCATION OF REPAIRS WITH OWNER PRIOR TO STARTING WORK. NOTIFY OWNER IF LAYOUT DOES NOT MATCH EXISTING CONDITIONS.
- 3. CONCRETE REPAIRS: REMOVE DIRT / DEBRIS AND PROVIDE GENERAL CLEANING OF PARKING LOT. REMOVE AND REPLACE AREAS OF CONCRETE THAT ARE BROKEN, SPALLING, RUTTING, CRACKED OR DETERIORATING. RE-STRIPE PARKING LOT WITH THE LAYOUT INDICATED ON DRAWING. COORDINATE LOCATION OF REPAIRS WITH OWNER PRIOR TO STARTING WORK. NOTIFY OWNER IF LAYOUT DOES NOT MATCH EXISTING CONDITIONS.
- 4. ADA PARKING: AREA TO BE CONVERTED TO ADA COMPLIANT DISABLED PARKING. REMOVE AND REPLACE ASPHALT AS REQUIRED TO ENSURE NEW ADA COMPLIANT DISABLED PARKING MEETS ALL REQUIREMENTS. RE-STRIPE PARKING LOT WITH THE LAYOUT INDICATED ON DRAWING. REFERENCE DETAIL DRAWING SHEETS.
- 5. SIGN POST: INSTALL NEW SIGN POST AND COORDINATE LANDSCAPING WITH OWNER.

Missouri State

UNIVERSITY

Planning | Design Construction

901 South National Avenue
Springfield, Missouri 65897
Phone: (417) 836-5101
Fax: (417) 836-6884
<https://design.missouristate.edu>

Project Title:

FY25 PARKING LOT MAINTENANCE, SPRINGFIELD CAMPUS

Project #: 250206-081

Issue Date: 03/31/2025

Drawn By: AJS

Sheet Title:

LOT 51 PLAN

Sheet #:

A-06

1
A-06

PARKING LOT 51

1" = 60'-0"



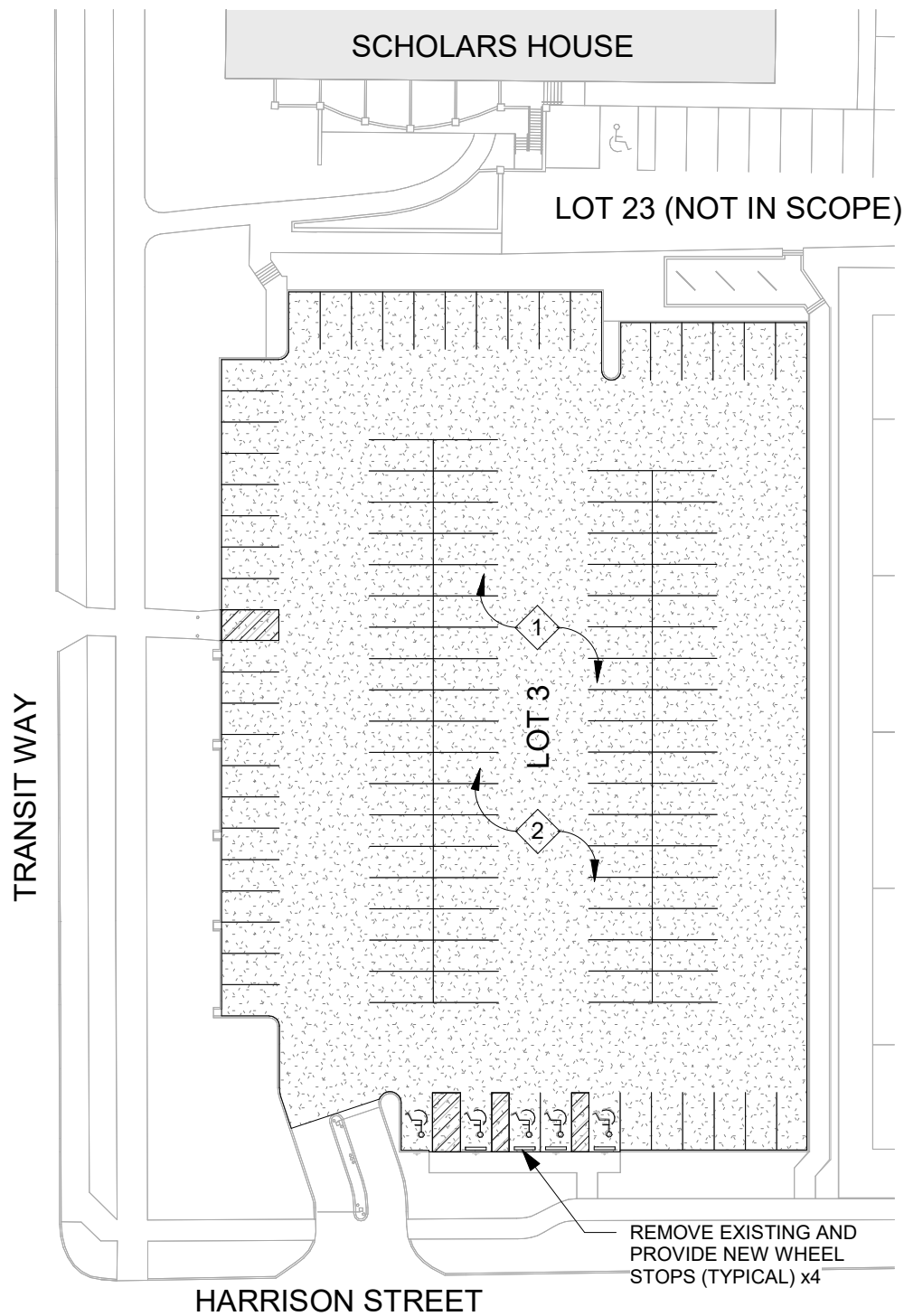

1

A-07

PARKING LOT 3

1" = 50'-0"



GENERAL NOTES

1. SEE SHEET AT A-01 FOR OVERALL SCOPE SUMMARY OF WORK.
2. ALL EXISTING SIGNS, WHEEL STOPS, UTILITIES, LIGHT POLES TO REMAIN, UNLESS OTHERWISE NOTED. NOTIFY PROJECT MANAGER IF EQUIPMENT IS DAMAGED AND NEEDS REPLACED.
3. CONTRACTOR TO VERIFY EXISTING CONDITIONS PRIOR TO BID.
4. ANY DAMAGE TO THE SITE OUTSIDE THE CONTRACT AREA SHALL BE THE RESPONSIBILITY OF THE CONTRACTOR. THE CONTRACTOR SHALL REPAIR OR REPLACE ANY SUCH ITEMS, PROVIDE LABOR, MATERIAL AND CLEAN-UP, AT THE CONTRACTOR'S EXPENSE AND TO THE SATISFACTION OF MSU WITHOUT ADDITIONAL COSTS.
5. CONTRACTOR IS TO BE AWARE OF UNDERGROUND COMMUNICATIONS, UNDERGROUND ELECTRIC AND THE CONTRACTOR IS TO USE CAUTION WHEN MAKING ADJUSTMENTS TO AND/OR WORKING ABOVE OR NEAR THESE UTILITIES. CONTRACTORS ARE RESPONSIBLE FOR LOCATING UTILITIES AS MAY BE NECESSARY TO AVOID DAMAGE.

KEYED NOTES

- 1

SEAL AND STRIPE: REMOVE DIRT / DEBRIS AND PROVIDE GENERAL CLEANING OF PARKING LOT. FILL ALL CRACKS AND SEAL PARKING LOT WITH AS SPECIFIED. RE-STRIPE PARKING LOT WITH THE LAYOUT INDICATED.
- 2

ASPHALT REPAIRS: REMOVE DIRT / DEBRIS AND PROVIDE GENERAL CLEANING OF PARKING LOT. REMOVE AND REPLACE AREAS OF ASPHALT THAT ARE BROKEN, SPALLING, RUTTING, CRACKED OR DETERIORATING. RE-STRIPE PARKING LOT WITH THE LAYOUT INDICATED ON DRAWING. COORDINATE LOCATION OF REPAIRS WITH OWNER PRIOR TO STARTING WORK. NOTIFY OWNER IF LAYOUT DOES NOT MATCH EXISTING CONDITIONS.
- 3

CONCRETE REPAIRS: REMOVE DIRT / DEBRIS AND PROVIDE GENERAL CLEANING OF PARKING LOT. REMOVE AND REPLACE AREAS OF CONCRETE THAT ARE BROKEN, SPALLING, RUTTING, CRACKED OR DETERIORATING. RE-STRIPE PARKING LOT WITH THE LAYOUT INDICATED ON DRAWING. COORDINATE LOCATION OF REPAIRS WITH OWNER PRIOR TO STARTING WORK. NOTIFY OWNER IF LAYOUT DOES NOT MATCH EXISTING CONDITIONS.
- 4

ADA PARKING: AREA TO BE CONVERTED TO ADA COMPLIANT DISABLED PARKING. REMOVE AND REPLACE ASPHALT AS REQUIRED TO ENSURE NEW ADA COMPLIANT DISABLED PARKING MEETS ALL REQUIREMENTS. RE-STRIPE PARKING LOT WITH THE LAYOUT INDICATED ON DRAWING. REFERENCE DETAIL DRAWING SHEETS.
- 5

SIGN POST: INSTALL NEW SIGN POST AND COORDINATE LANDSCAPING WITH OWNER.

Missouri State

UNIVERSITY

Planning | Design Construction

901 South National Avenue
Springfield, Missouri 65897
Phone: (417) 836-5101
Fax: (417) 836-6884
<https://design.missouristate.edu>

Project Title:

FY25 PARKING LOT MAINTENANCE, SPRINGFIELD CAMPUS

Project #: 250206-081

Issue Date: 03/31/2025

Drawn By: AJS

Sheet Title:

LOT 3 PLAN (ALTERNATE)

Sheet #:

A-07

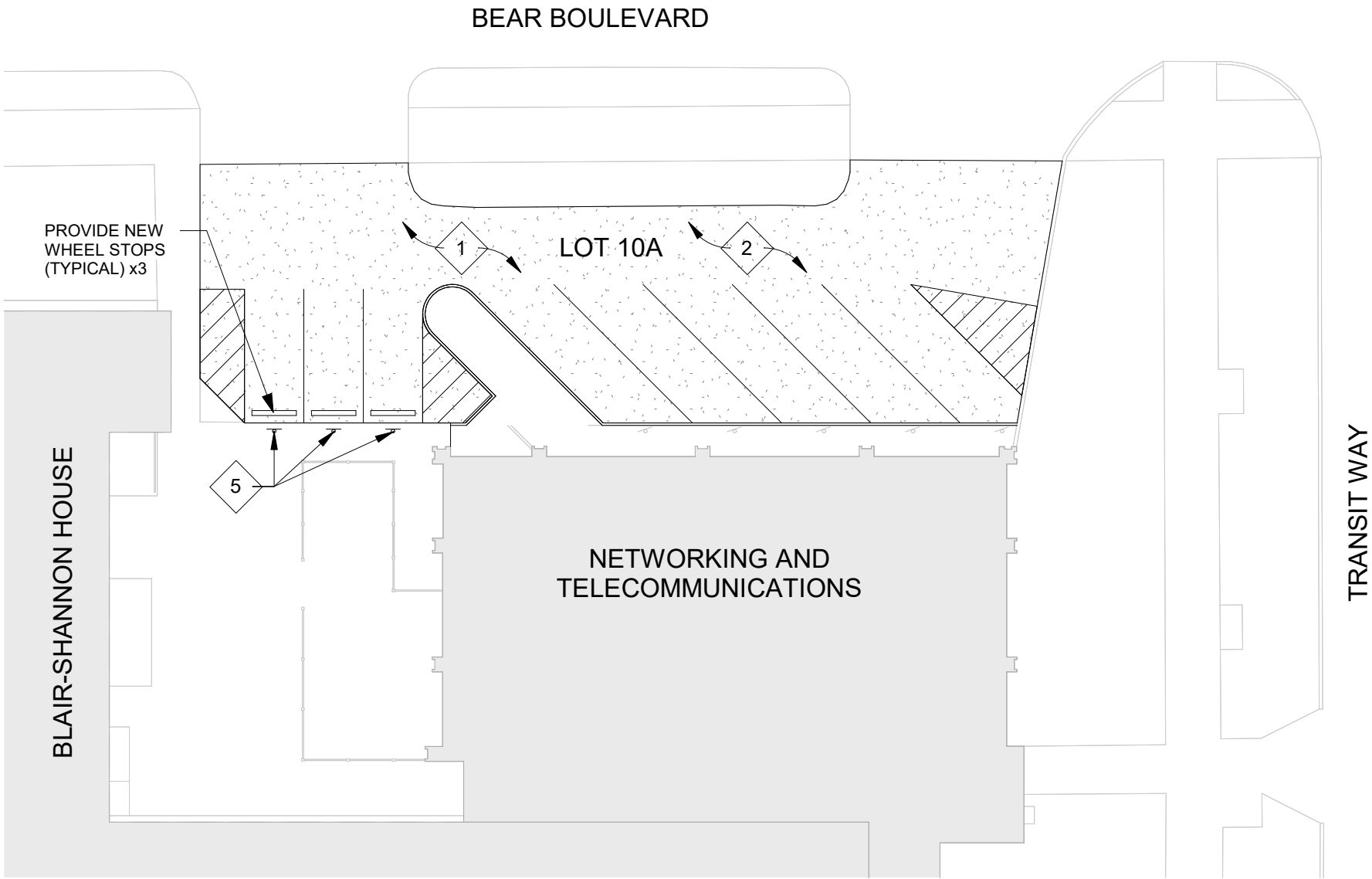

1
A-08 **PARKING LOT 10A**
1" = 20'-0"

GENERAL NOTES

- 1. SEE SHEET AT A-01 FOR OVERALL SCOPE SUMMARY OF WORK.
- 2. ALL EXISTING SIGNS, WHEEL STOPS, UTILITIES, LIGHT POLES TO REMAIN, UNLESS OTHERWISE NOTED. NOTIFY PROJECT MANAGER IF EQUIPMENT IS DAMAGED AND NEEDS REPLACED.
- 3. CONTRACTOR TO VERIFY EXISTING CONDITIONS PRIOR TO BID.
- 4. ANY DAMAGE TO THE SITE OUTSIDE THE CONTRACT AREA SHALL BE THE RESPONSIBILITY OF THE CONTRACTOR. THE CONTRACTOR SHALL REPAIR OR REPLACE ANY SUCH ITEMS, PROVIDE LABOR, MATERIAL AND CLEAN-UP, AT THE CONTRACTOR'S EXPENSE AND TO THE SATISFACTION OF MSU WITHOUT ADDITIONAL COSTS.
- 5. CONTRACTOR IS TO BE AWARE OF UNDERGROUND COMMUNICATIONS, UNDERGROUND ELECTRIC AND THE CONTRACTOR IS TO USE CAUTION WHEN MAKING ADJUSTMENTS TO AND/OR WORKING ABOVE OR NEAR THESE UTILITIES. CONTRACTORS ARE RESPONSIBLE FOR LOCATING UTILITIES AS MAY BE NECESSARY TO AVOID DAMAGE.

KEYED NOTES

- 1 SEAL AND STRIPE: REMOVE DIRT / DEBRIS AND PROVIDE GENERAL CLEANING OF PARKING LOT. FILL ALL CRACKS AND SEAL PARKING LOT WITH AS SPECIFIED. RE-STRIPE PARKING LOT WITH THE LAYOUT INDICATED.
- 2 ASPHALT REPAIRS: REMOVE DIRT / DEBRIS AND PROVIDE GENERAL CLEANING OF PARKING LOT. REMOVE AND REPLACE AREAS OF ASPHALT THAT ARE BROKEN, SPALLING, RUTTING, CRACKED OR DETERIORATING. RE-STRIPE PARKING LOT WITH THE LAYOUT INDICATED ON DRAWING. COORDINATE LOCATION OF REPAIRS WITH OWNER PRIOR TO STARTING WORK. NOTIFY OWNER IF LAYOUT DOES NOT MATCH EXISTING CONDITIONS.
- 3 CONCRETE REPAIRS: REMOVE DIRT / DEBRIS AND PROVIDE GENERAL CLEANING OF PARKING LOT. REMOVE AND REPLACE AREAS OF CONCRETE THAT ARE BROKEN, SPALLING, RUTTING, CRACKED OR DETERIORATING. RE-STRIPE PARKING LOT WITH THE LAYOUT INDICATED ON DRAWING. COORDINATE LOCATION OF REPAIRS WITH OWNER PRIOR TO STARTING WORK. NOTIFY OWNER IF LAYOUT DOES NOT MATCH EXISTING CONDITIONS.
- 4 ADA PARKING: AREA TO BE CONVERTED TO ADA COMPLIANT DISABLED PARKING. REMOVE AND REPLACE ASPHALT AS REQUIRED TO ENSURE NEW ADA COMPLIANT DISABLED PARKING MEETS ALL REQUIREMENTS. RE-STRIPE PARKING LOT WITH THE LAYOUT INDICATED ON DRAWING. REFERENCE DETAIL DRAWING SHEETS.
- 5 SIGN POST: INSTALL NEW SIGN POST AND COORDINATE LANDSCAPING WITH OWNER.

Missouri State

UNIVERSITY

Planning | Design Construction

901 South National Avenue
Springfield, Missouri 65897
Phone: (417) 836-5101
Fax: (417) 836-6884
<https://design.missouristate.edu>

Project Title:

FY25 PARKING LOT MAINTENANCE, SPRINGFIELD CAMPUS

Project #: 250206-081

Issue Date: 03/31/2025

Drawn By: AJS

Sheet Title:

LOT 10A PLAN (ALTERNATE)

Sheet #:

A-08

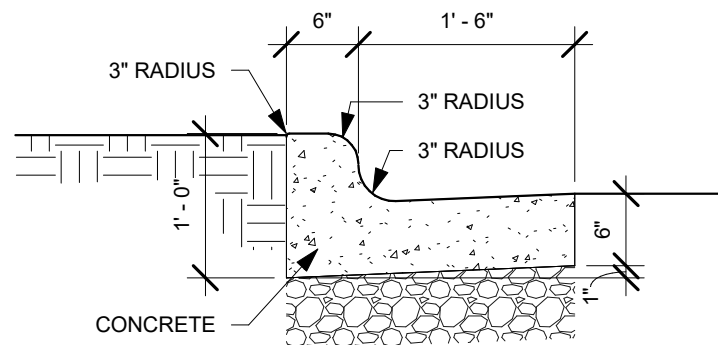

CURB NOTES:

1. USE SPILL CURB WHERE GRADING INDICATES DRAINAGE AWAY FROM CURB.
2. USE STANDARD CURB WHERE GRADING INDICATES DRAINAGE TOWARD CURB.
3. CONTRACTION JOINTS AT 20' MAXIMUM INTERVALS
EXPANSION JOINTS AT ALL POINTS OF BEGINNING CURVATURE AND TANGENCY.
4. PROVIDE MINIMUM 6" AGGREGATE BASE BELOW CURB AND GUTTER.

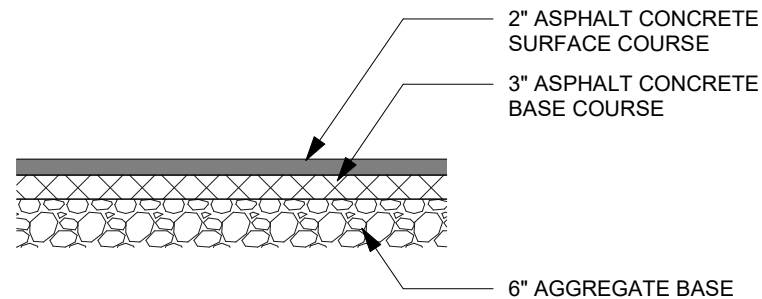

3 Curb and Gutter

A-09 3/4" = 1'-0"

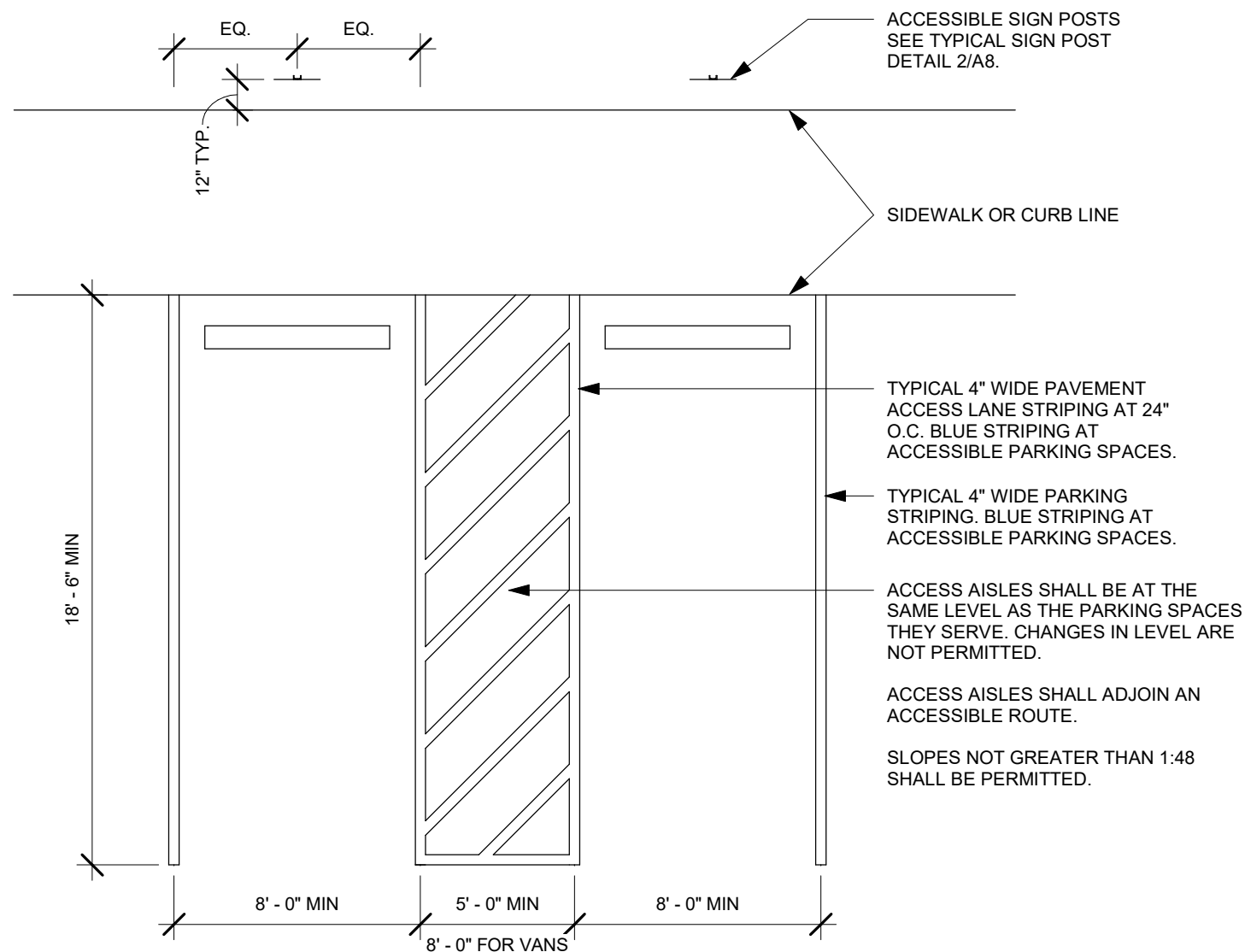

1 ADA Accessible Parking Aisle Width for Cars

A-09 3/16" = 1'-0"

4 Typ. Asphalt Pavement

A-09 1/2" = 1'-0"

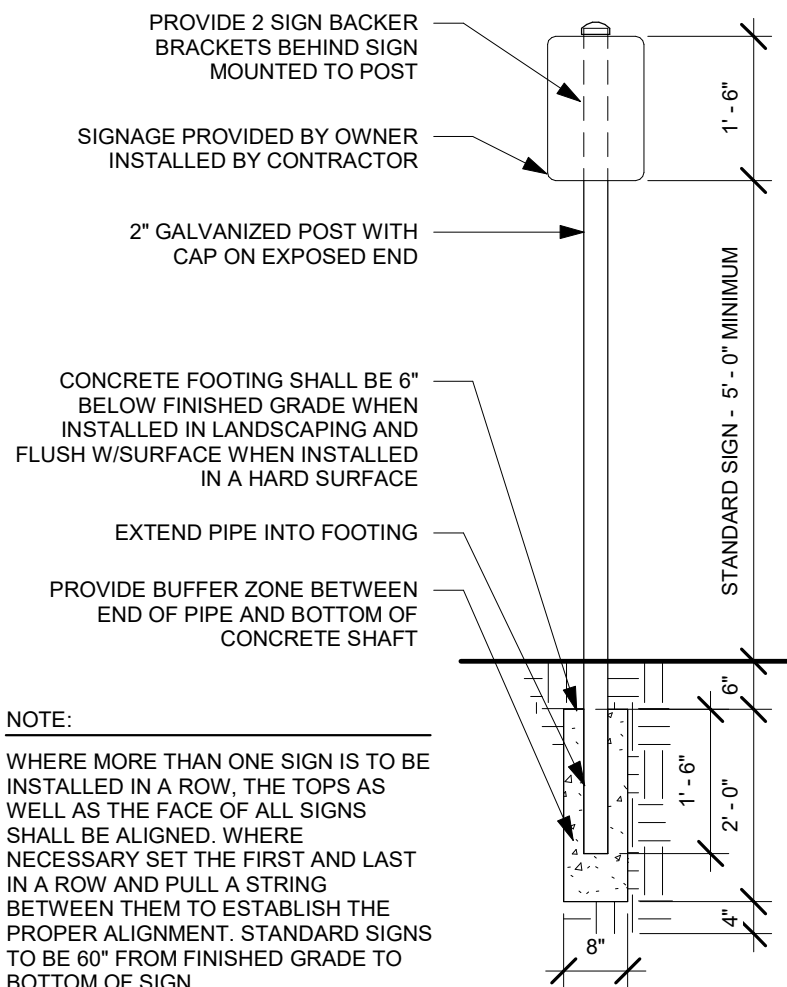

2 Typical Sign

A-09 1/2" = 1'-0"

Project Title:

**FY25 PARKING LOT
MAINTENANCE,
SPRINGFIELD
CAMPUS**

Project #: **250206-081**

Issue Date: **03/31/2025**

Drawn By: **AJS**

Sheet Title:

DETAILS

Sheet #:

A-09

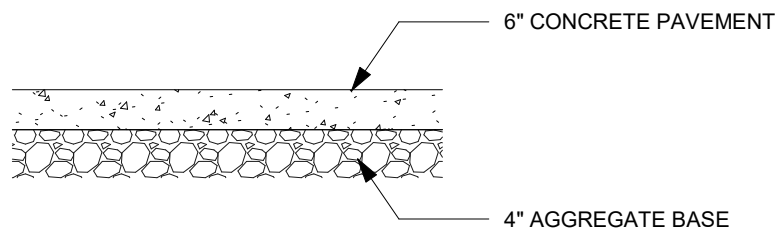

1 **Typ. Concrete Pavement**
A-10 1/2" = 1'-0"

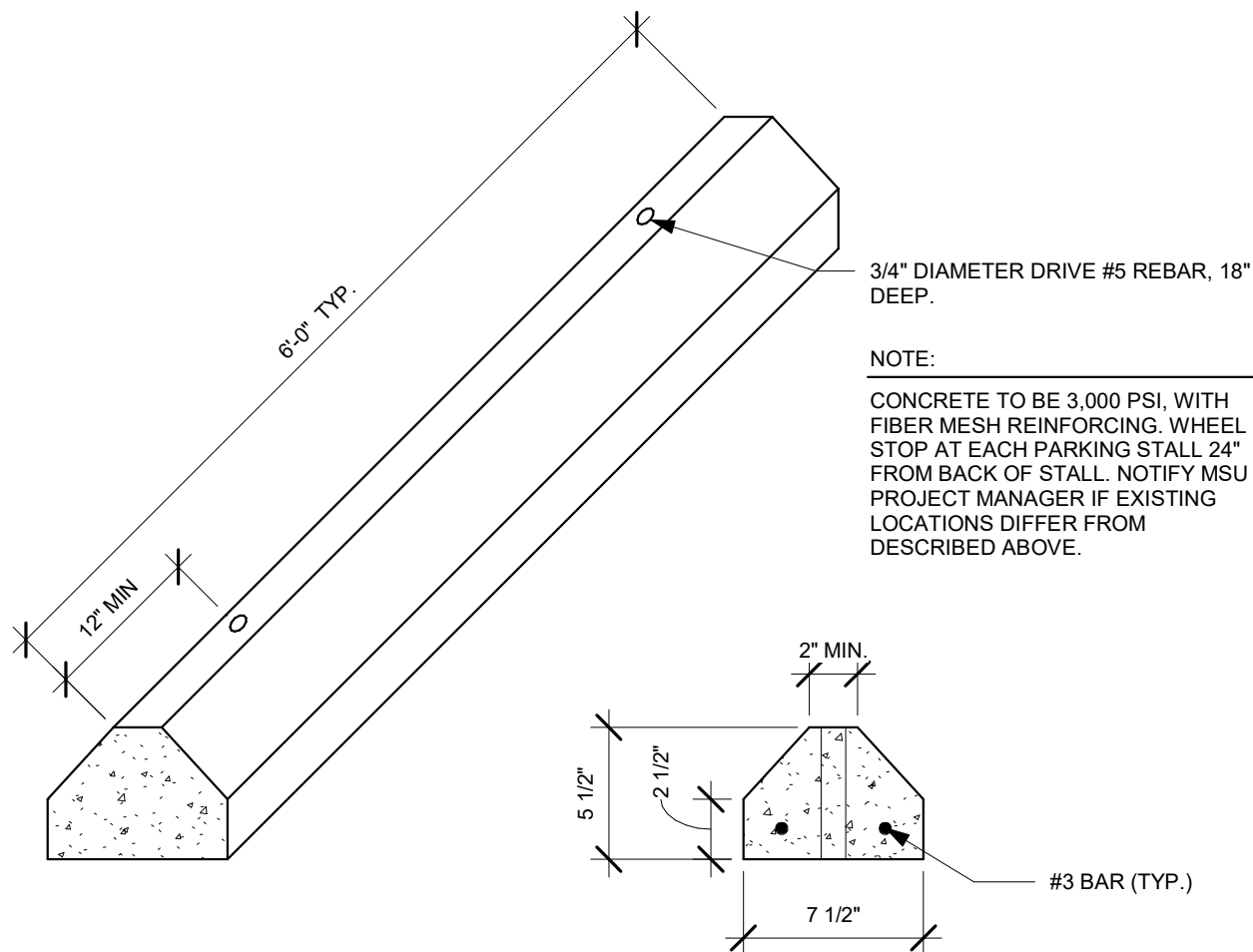

2 **Wheel Stop**
A-10 1 1/2" = 1'-0"

Project Title:

**FY25 PARKING LOT
MAINTENANCE,
SPRINGFIELD
CAMPUS**

Project #: **250206-081**

Issue Date: **03/31/2025**

Drawn By: **AJS**

Sheet Title:

DETAILS

Sheet #:

A-10